

**T300 SERIES TUBULAR LOCKSETS** **T-1**

Brookline Tubular Levers are a cost effective option to maintain the continuity of design when moving from a commercial application to a residential application. Our locks are engineered to provide a suitable alternative to the standard lesser grade cylindrical option. Brookline tubular sets are available in any of our mortise designs with rose trim.

**T300 Series Tubular Locks**  
For Interior Use

- T301** Single Dummy Inside
- T302** Full Dummy Set
- T303** Single Dummy Outside
- T310** Passage Set
- T325** Communicating Lock
- T340** Privacy Lock



Available in 605, 606, 610, 613, 619, 626, 629, 630

**Specifications**

- 2-3/4”(70mm) Backset Standard 2-3/8” Optional
- Thru-Bolted Trim For Maintaining Alignment
- Faceplate 1”(25.4mm) x 2-1/4”(57mm)
- Available in 2-1/4”(57mm) or 2-9/16”(65mm) Dia Rose
- Door Thickness 1-3/4”(70mm)
- Nylon Subplate to Maintain Proper Latchbolt Alignment

**T310 Passage Set**  
Exploded View

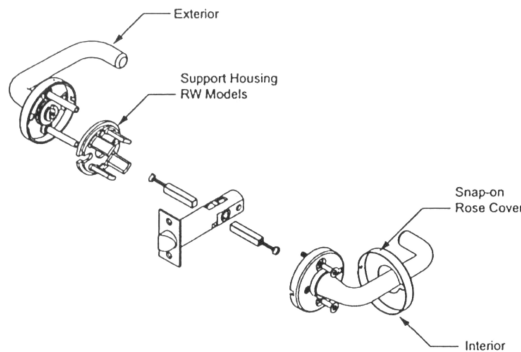

**T340 Privacy Set**  
Exploded View

